



Number 16

### New Stainless Steel Nut and Washer

Ace is implementing a product improvement for the optional stainless steel impeller attachment nut and washer. The new components provide improved clamping force and locking function. Additionally, the standard nut prevents galling that may occur when applying a stainless steel nut on a stainless steel shaft.

- ✓ A standard 3/8" stainless steel nut is replacing the previous flex-lock nut. This nut provides the corrosion prevention needed for aggressive chemicals and fertilizers.
- ✓ A vibration proof washer replaces the current star type lock washer. The washer is a two piece assembly that is bonded together. If the two parts separate, the serrated faces should be oriented as shown.
- ✓ The new nut and washer must be used together for proper function and may also be used in the repair of older pumps.
- ✓ Application of copper based anti-seize compound is recommended on the impeller bore, key, and shaft threads to facilitate future pump service.

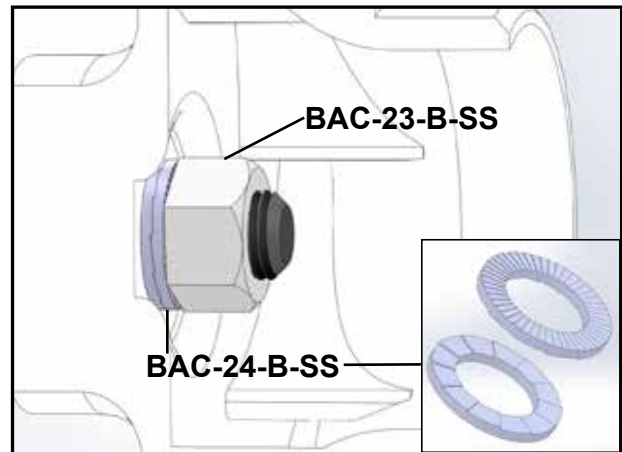

New Part	EDP #	Description	Replaces	EDP #	Description
BAC-23-B-SS	40393	Nut, 3/8" NF, SS	BAC-23-A-SS	40392	Nut, 3/8" flex-lock, SS
BAC-24-B-SS	42702	Washer, 3/8" SS, vibration proof	BAC-24-HYD-SS	40400	Washer, 3/8", SS

This change is effective October 2012 for the following:

Pump Series	Description
-SS Models	All FMC, FMC-150, PTOC-150, and FMC-200 Series pumps with a keyed shaft attachment and the "-SS" stainless fitted adder.
FMC-150FS-HYD Models	All 150 Series stainless steel pumps
FMC-200SS-HYD Models	All 200 Series stainless steel pumps
FMC-205F-HYD Models	All 205 Series pumps